







# VOMERE SGOMBRA NEVE

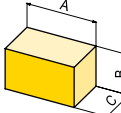

# CARATTERISTICHE TECNICHE

Modello	um	VB 180	VB 210	VB 240	VB 270	VB 280	VB 300	VB 320	
Larghezza lavoro con lame dritte	D mm	1800	2100	2400	2700	2800	3060	3260	
Larghezza lavoro con lame piegate	E F G mm	1490	1730	1990	2230	2260	2450	2635	
Altezza lame	A mm	750		940		1015			
Pressione olio max	bar	240							
Peso dotazione standard	kg	360	400	580	620	710	760	810	
Altezza max superabile	B mm	120		130		140			
	C mm	1210		1430		1450			
Inclinazione flottante a molla		± 10°							
Rotazione idraulica delle lame	mm	± 35°							
	ton	1,6 - 2,2	2,0 - 3,2	3,0 - 4,2	3,8 - 4,8	---	---	---	
	ton	2,0 - 3,0	2,9 - 4,2	3,8 - 4,8	4,2 - 5,4	5,2 - 7,0	6,4 - 8,2	7,6 - 8,8	
	ton	3,0 - 3,8	3,2 - 4,6	4,2 - 5,4	4,8 - 5,8	5,6 - 7,8	7,0 - 8,6	7,4 - 9,0	
	ton	---	4,0 - 5,0	4,4 - 5,4	4,8 - 5,8	5,2 - 6,8	5,8 - 8,0	6,8 - 9,0	
<b>Dimensioni d'ingombro senza optional</b>		A cm	180	210	240	270	280	306	326
		B cm	75	75	94	97	102	102	102
		C cm	121	121	143	143	145	145	145

## Dimensioni lavoro

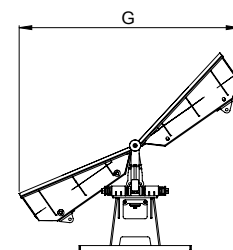
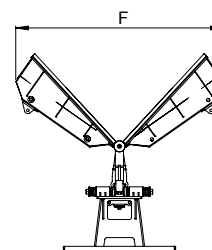
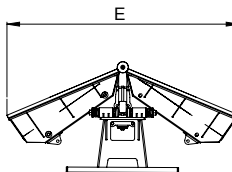
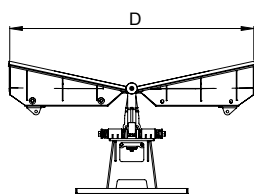
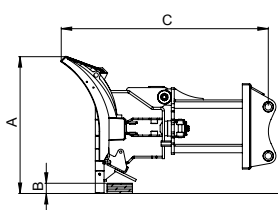

## Kit luci di ingombro

Optional per i mod. VB180 / VB210 / VB240 / VB270  
Di serie per i mod. VB280 / VB300 / VB320



**G.F. Gordini srl**

Via E. Mattei, 4 - 48012 Bagnacavallo RA - Italy

tel. +39 0545 62712 fax +39 0545 62140

info@gfgordini.com - www.gfgordini.com

**ACCESSORI PER MACCHINE OPERATRICI**

I dati e le immagini contenute nella Scheda Tecnica sono puramente indicativi, pertanto GF Gordini srl si riserva il diritto di apportare modifiche migliorative dei prodotti senza nessun obbligo di preavviso